

Pinkwood® PKI15 Rim joists

Notch and Hole Allowances

Joist Rim Notching and Penetrations

When PKI15 Series I-joists are used as rim, conditions may exist in which the rim joist needs to be notched for concrete hold down bolts or penetrated for exterior venting. The following guideline provides details showing the allowance modifications for these conditions.

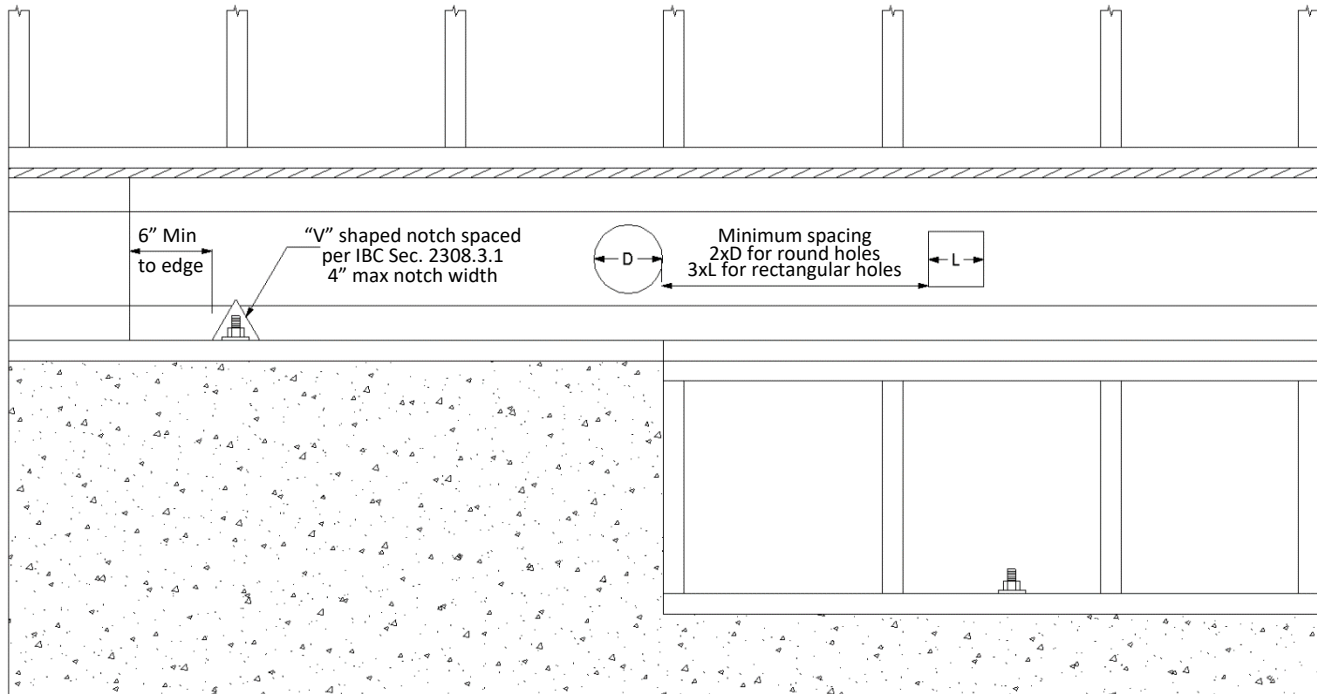

General Notes:

- PKjoists series PKI15 used as rim are limited to depths of 9-1/2", 11-7/8" and 14".
- Round holes are limited to diameters listed in IAPMO UES-ER431.
- Maximum size round rolls are required to be centered vertically within the joist height.
- Rectangular and Square holes sizes are limited to those listed in IAPMO UES-ER431.
- Maximum size rectangular and square holes are required to be vertically centered within the joist height.
- Distances between holes, notches and rim edges are as indicated above.
- No not location notches or penetration under concentrated loads.
- The above detail is for lateral load allowances per ANSI/AWC SDPWS Section 4.2.7.1.1.3.
- Vertical loading conditions are as outlined in IAPMO UES-ER431.
- Notches and penetrations outside those listed above require review by a licensed design professional.

If you have any questions, please contact Pinkwood Ltd. for details.



5929 6th Street NE, Calgary, Alberta, CANADA, T2K 5R5

Ph: 855.279.3700 www.Pinkwood.ca

TECHNICAL BULLETIN

TB20

January 2020 (Expires 1/1/2022)