

# Pinkwood PKjoists®

## Web Repair with Services Remaining

### I-joist web repair for holes

When holes are cut in the wrong location through the web of a PKjoist®, it is recommended to remove the service item and patch the hole per **TB12 "Standard Web Repair"**. When this is not practical and the penetrating item must remain as placed, the following detail can be used to restore the joist allowable shear with the following hole size and location restrictions.

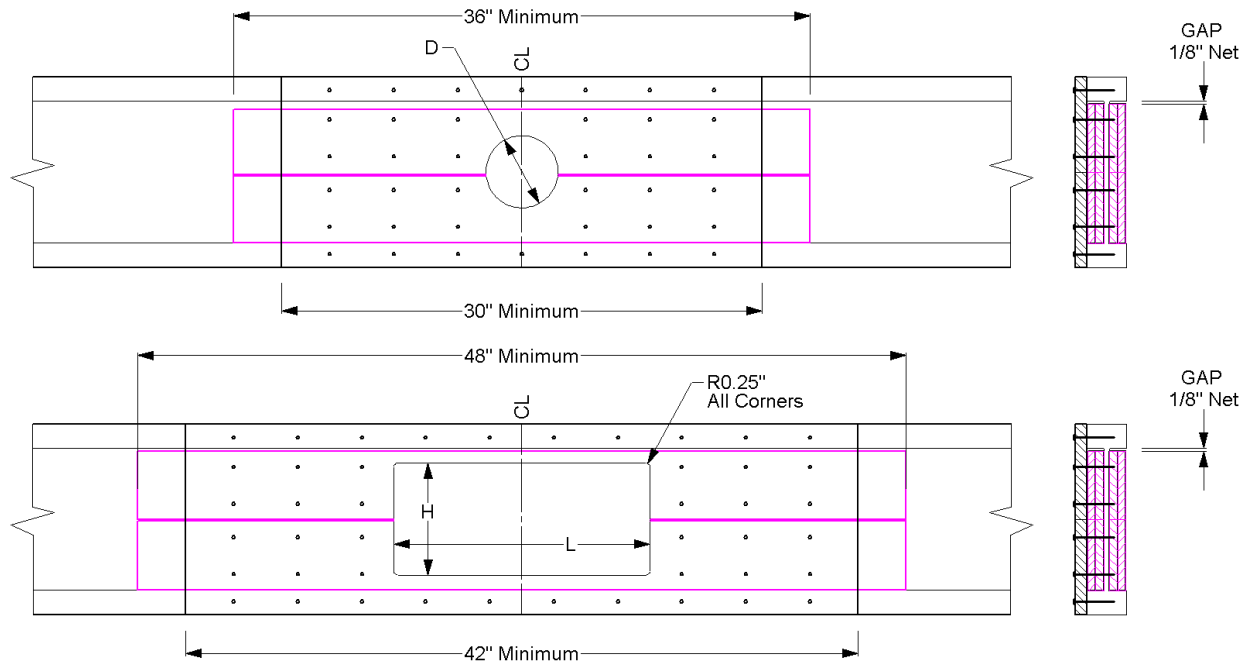

### Restrictions

Joist Series	Joist Depth	Penetration within First 1/3 Span			Penetration within Middle 1/3 Span		
		Round	Rectangular		Round	Rectangular	
		Max (D)	Max (L)	Max (H)	Max (D)	Max (L)	Max (H)
PKI 15	9-1/2"	3-1/2"	12"	3-1/2"	4-1/2"	16"	4"
	11-7/8"	4"	14"	5-1/2"	6-7/8"	18"	6-3/8"
PKI 10, 20, 23, 35Plus, 40, 50	9-1/2"	4-1/2"	14"	5"	6-1/2"	16"	6"
	11-7/8"	5"	16"	7"	8-7/8"	18"	8-3/8"
	14"	5-1/2"	18"	8-1/2"	11"	18"	10-1/2"
	16"	6-1/2"	18"	10"	13"	18"	12-1/2"

### Installation Notes

1. Fill web with rated sheathing flush to outside of flanges, both sides, cut tightly around hole.
2. Apply construction adhesive to all contact surfaces of panel pieces.
3. Apply second layer of 23/32" rated panel, one side, cut tightly around hole.
4. Apply construction adhesive to entire backside and top edge of panel.
5. Secure to flanges and base layer with 8d nails x 2.5" long, 6 rows at 4" o.c.

If you have any questions, please contact Pinkwood Ltd. for details.

