

Pinkwood PKjoists®

Gypsum Board Shoring Requirements

Limitations without joist support

Stacking gypsum board onto unsupported or un-shored PKjoist is permitted with the following limitations:

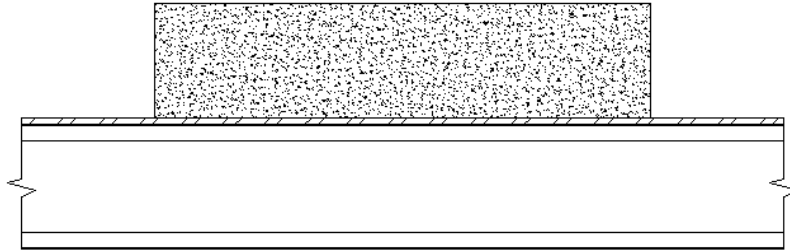

- Gypsum board is limited to 22 sheets of ½" board or 17 sheets of 5/8" board, or a combination of the two not to exceed 11-inches total in height.
- Gypsum board must be stacked within 24-inches of a bearing wall or end support below.
- Gypsum board stacks are limited to single joists. PKjoists may not be used to support more than a single stack of gypsum board.
- Gypsum boards are to be stacked perpendicular to the joist span direction.
- Gypsum board shall only be applied to joist which are dried in and are not subject to exterior weather conditions.
- Gypsum board stacks are allowed for a maximum of 4 weeks.

Limitations with joist support to bottom flange

Stacking gypsum board onto bottom flange supported or shored PKjoist is permitted with the following limitations:

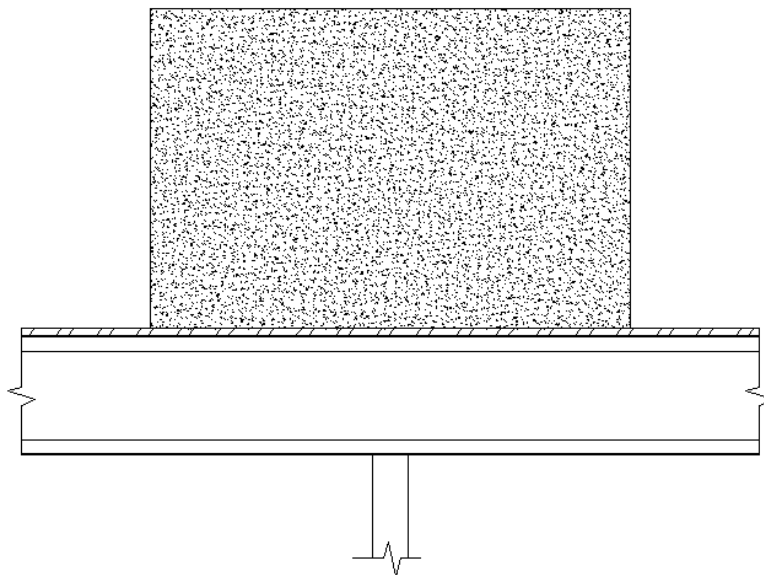

Pinkwood PKjoists®

Gypsum Board Shoring Requirements

- **Gypsum weight, stacked loads and load transfer are the responsibility of the licensed design professional and must be pre-approved prior to stacking.**
- Gypsum board is limited to 60 sheets of ½" board or 48 sheets of 5/8" board, or a combination of the two not to exceed 30-inches total in height.
- Temporary shoring support must provide 3.5-inch of support to the bottom flange of each joist.
- Center of gypsum board must be stacked within 12-inches of the temporary shoring support.
- Gypsum board stacks are limited to single joists. PKjoists may not be used to support more than a single stack of gypsum board.
- Gypsum boards are to be stacked perpendicular to the joist span direction.
- PKjoist spacing shall not exceed 24" on-center spacing.
- Gypsum board shall only be applied to joist which are dried in and are not subject to exterior weather conditions.
- Gypsum board stacks are allowed for a maximum of 4 weeks.

Limitations with support directly to subfloor

Stacking gypsum board onto subfloor directly supported and shored is permitted with the following limitations:

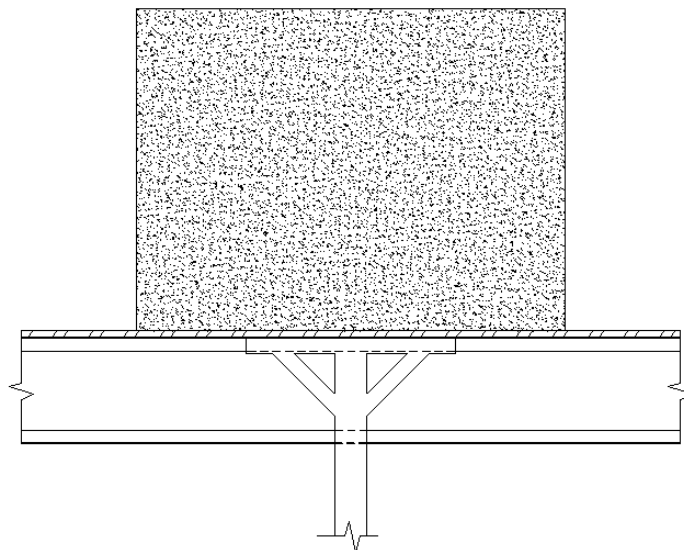

- **Gypsum weight, stacked loads and load transfer are the responsibility of the licensed design professional and must be pre-approved prior to stacking.**
- **Temporary shore bracing quantity, location, and support direction are the responsibility of the licensed design professional and must be pre-approved prior to stacking.**

If you have any questions, please contact Pinkwood Ltd. for details.



5929 6th Street NE, Calgary, Alberta, CANADA, T2K 5R5
Ph: 855.279.3700 www.Pinkwood.ca

TECHNICAL BULLETIN
TB07

January 2020 (Expires 1/1/2022)