

PinkWood PKI[®] Joists

Top Flange Notch Allowance for Plumbing – Canada (LSD)

Top flange notch allowance:

When plumbing ducts/fittings/fixtures are too close to the floor/roof joists, it is advisable to shift the joist away from such fixtures by a max. offset distance of 3" to prevent inadvertently cutting the joist top flange. When this is not possible, or when offsetting the joist was missed during construction, a 0.5" top flange notch is allowed providing that the web is intact and the notch location, width, and length are as indicated below.

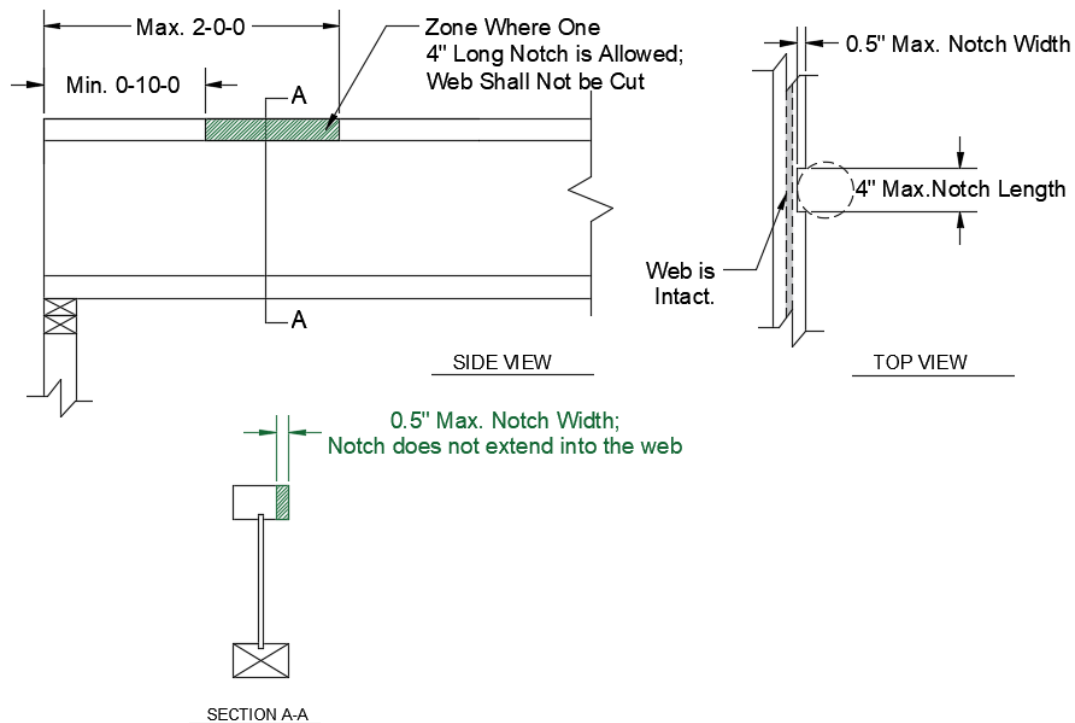

NOTE: When top flange notches are within the guidelines listed above, no repair engineering or sealed calculations are required.